

SPARE PARTS

SISTEM MHD'

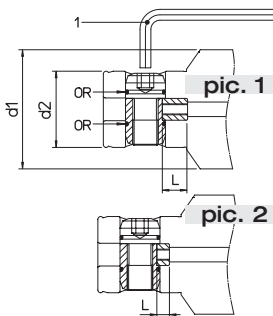

REF.	CODE	d1	d2	CODE 1	CODE OR	L	pic.
MHD' 16	381725001161	16	10	101500100250		2	2
MHD' 20	381725001201	20	13	101500100300		2.5	2
MHD' 25	381725001251	25	16	101500100300		3	2
MHD' 32	381725001321	32	20	101500100400	101254007510	3.55	2
MHD' 40	381725001401	40	25	101500100500	101254010010	4	2
MHD' 50 RD 50 / .. TRM - TRC - TR-E	381725001501	50	32	101500100600	101254013010	4.2	2
MHD' 50	381725001001	50	32	101500100600	101254013010	12.2	1
MHD' 63-80 RD 63 / .. TRM - TRC	381725001502	63-80	42	101500100800	101251002075	4.9	2
MHD' 63-80	381725001002	63-80	42	101500100800	101251002075	13.85	1

MHD' - PSC / TRM

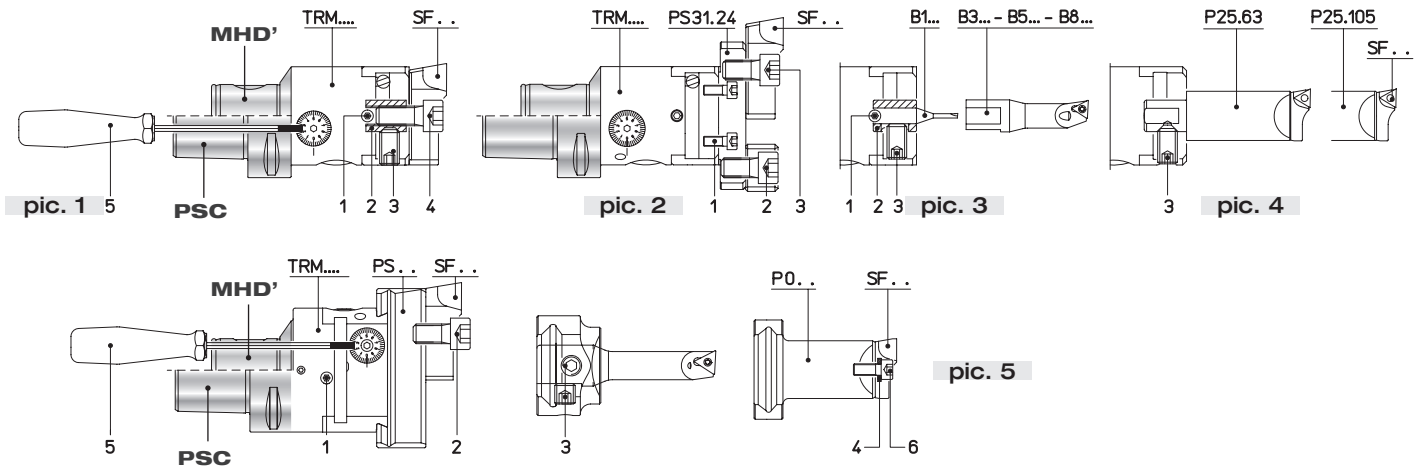

REF.	CODE 1	CODE 2	CODE 3	CODE 4	CODE 5	CODE 6	pic.
TRM 16 MHD'	200100190301			100051030006	101500800150		1
TRM 20 MHD'	200100190301			100051040008	101500800150		1
TRM 25 MHD'	100271040004			100051050010	101500800200		1
TRM 32 MHD'	100271040006			100051060012	101500800200		1
TRM 40 MHD'	100271050005			100051080014	101500800250		1
TRM 50 MHD' PSC50-TRM50 PSC63-TRM50	100271050008	201041015002	100231100016	100051100025	101500800250		1
TRM 50 MHD' PSC50-TRM50 PSC63-TRM50	200100150501	100051100020	100051100020		101500800250		2
TRM 50 MHD' PSC50-TRM50 PSC63-TRM50	100271050008	200560116082	100231100016		101500800250		3-4
TRM 63 MHD' PSC63-TRM63	100251060010	100051100018	100251080008	100051050012	101500800300	100800100530	5
TRM 80-MHD' PSC63-TRM80	100251060014	100051100018	100251080008	100051050012	101500800300	100800100530	5
TRM 125 MHD'	100251060020	100051100025		100051060018	101500800300	100800100640	5

TRE 50

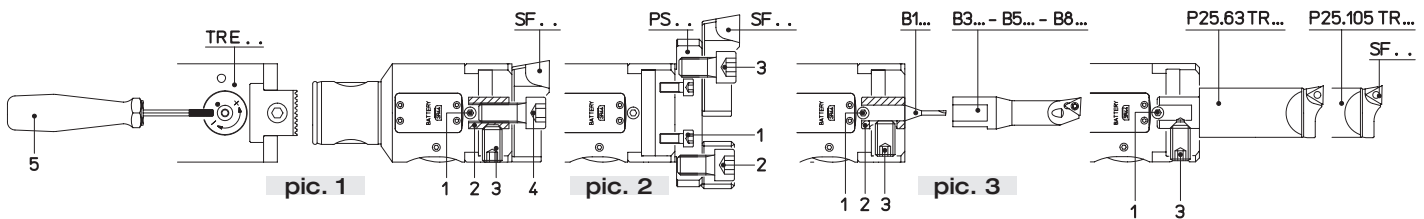

REF.	CODE 1	CODE 2	CODE 3	CODE 4	CODE 5	pic.
TRE 50	100238060010	201041015002	100231100016	100051100025	101500800250	1
TRE 50	200100150501	100051100020	100051100020			2
TRE 50	100238060010	200560116082	100231100016			3

TRC

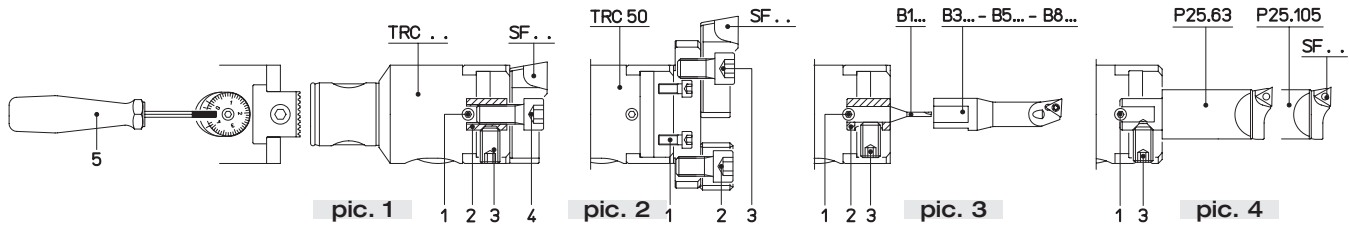

REF.	CODE 1	CODE 2	CODE 3	CODE 4	CODE 5	pic.
TRC 16	200100190301			100051030006	101500800150	1
TRC 20	200100190301			100051040008	101500800150	1
TRC 25	100271040004			100051050010	101500800150	1
TRC 32	100271050005			100051060012	101500800250	1
TRC 40	100271060006			100051080014	101500800300	1
TRC 50	100271060008	201041015002	100231100016	100051100025	101500800300	1
TRC 50	200100150501	100051100020	100051100025			2
TRC 50	100271060008	200560116082	100231100010			3-4
TRC 63	100271060008			100051100020	101500800300	1
TRC 80	100271060012			100051100025	101500800300	1

MHD' - PSC / TS

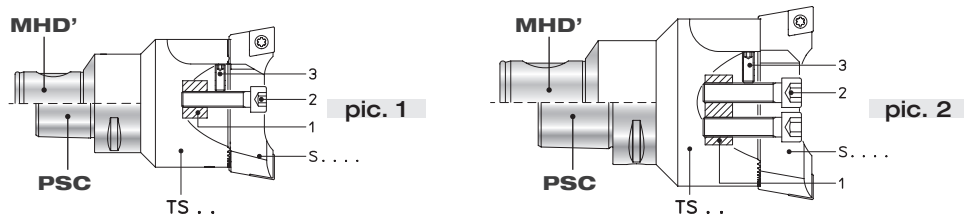

REF.	CODE 1	CODE 2	CODE 3	pic.
TS 16/16 MHD'	201430110008	100051030014	100231030004	1
TS 20/20 MHD'	201430110009	100051040015	100231030005	1
TS 25/25 MHD'	201430110032	100051040020	100231030008	1
TS 32/32 MHD'	201430110031	100051050025	100231040012	1
TS 40/40 MHD'	201430110029	100051060030	100231050014	1
TS 50/50 MHD' - PSC50-TS50 / PSC63-TS50	201430110013	100051080035	100231050012	1-2
TS 50/63 MHD'	201430110030	100051100040	100231060016	2
TS 63/63 MHD' - PSC63-TS63	201430110030	100051100040	100231060016	1-2
TS 80/80 MHD' - PSC63-TS80	201430110015	100051120045	100231080025	1-2
TS 80/90 MHD'	201430110015	100051120045	100231080025	1-2

BHT 250 - 500

ROUGHING BHT 250 SG - BHT 500 SG

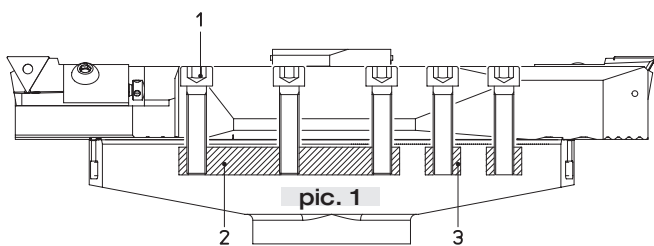

FINISHING BHT 250 FN - BHT 500 FN

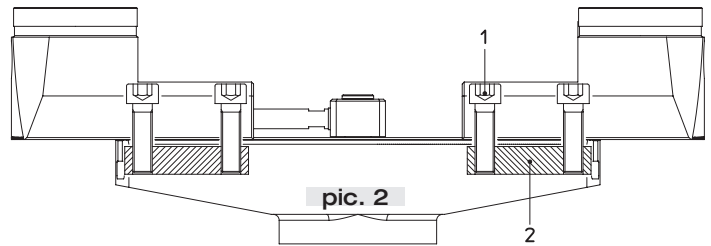

REF.	CODE 1	CODE 2	CODE 3
ROUGHING pic. 1	BHT 250 SG - BHT 500 SG	100051100045	201430100065
FINISHING pic.2	BHT 250 FN - BHT 500 FN	100051100035	201430100066

SPARE PARTS

PE - MHD' ER DIN 6499

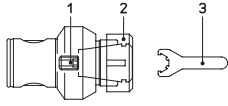

REF.	CODE 1	CODE 2	CODE 3
PE 20 / ER16M	200100190403	100451011600	101501001600
PE 32 / ER25M	200100190608	100451012500	101501002500
PE 40 / ER25	200100190808	100451032500	101501002501
PE 50 / ER25	200100190808	100451032500	101501002501
PE 50 / ER32	200100190808	100451033200	101501003201
PE 63 / ER32	200100191014	100451033200	101501003201

PE - PSC / MONOd ER DIN 6499

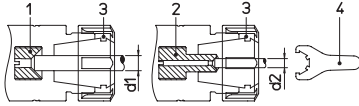

REF.	CODE 1	d1	CODE 2	d2	CODE 3	CODE 4
ER 16 M	201082010001	5 ~ 10	201082010002	1 ~ 4	100451011600	101501001600
ER 25	201082018001	8 ~ 16	201082018002	2 ~ 7	100451032500	101501002501
ER 32	201082022001	8 ~ 20	201082022002	3 ~ 7	100451033200	101501003201

AW DIN 1835 B-E

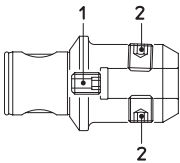

REF.	CODE 1	CODE 2	REF.	CODE 1	CODE 2
AW 50/6	200100190808	200100190610	AW 50/25	200100191615	200100191820
AW 50/8	200100190808	200100190810	AW 63/16	200100191215	200100191416
AW 50/10	200100190809	200100191012	AW 63/20	200100191215	200100191616
AW 50/12	200100190809	200100191216	AW 63/25	200100191615	200100191820
AW 50/14	200100190809	200100191216	AW 63/32	200100191615	200100192020
AW 50/16	200100191215	200100191416	AW 80/40	200100192019	200100192020
AW 50/20	200100191215	200100191616			

PF MHD' - PSC



REF.	CODE 1	CODE 2	CODE 3	CODE 4	CODE 5
PF 40/16	201010085010	201101800801	101001040014	100101080025	100051030008
PF 40/22	201010105030	201101801002	101001060016	100101100025	100051040010
PF 50/16	201010085010	201101800801	101001040014	100101080025	100051030008
PF 50/22 MHD' / PSC50-PF22.25	201010105030	201101801002	101001060016	100101100025	100051040010
PF 50/27 MHD' / PSC50-PF27.25	201010125030	201101801202	101001070018	100101120030	100051050012
PF 50/32	201010165020	201101801402	101001080020	100101160035	100051060016
PF 63/22	201010105030	201101801002	101001060016	100101100025	100051040010
PF 63/27 MHD' / PSC63-PF27.25	201010125030	201101801202	101001070018	100101120030	100051050012
PF 63/32 MHD' / PSC63-PF32.25	201010165020	201101801402	101001080020	100101160035	100051060016
PF 80/32 MHD' / PSC80-PF32.30	201010165020	201101801402	101001080020	100101160035	100051060016
PF 80/40 MHD' / PSC80-PF40.45	201010210010	201101801603	101001100025	100101200045	100051060018
PF 80/50	201010260330	201101801802	101001120028	100101240050	100051060020
PF 80/60		201101802510	101001140036		100051120025

PSC

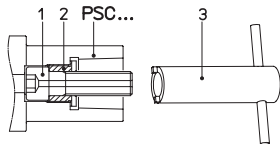

PSC	CODE 1	CODE 2	CODE 3
40	200101151448	201032215005	101501402101
50	200101151658	201032515005	101501402401
63	200101152071	201033015021	101501403001
80	200101152071	201033015021	101501403001

FORCE VCR SETTING SCREW FOR INTERNAL COOLANT SUPPLY

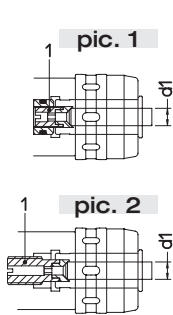

pic.	REF.	CODE 1	d1	pic.	REF.	CODE 1	d1
1	VCR 20 MONOforce 20	382041020032	3 ~ 5	2	VCR 20 MONOforce 20	382041020031	3 ~ 5
	HSK63-100 MHD'50	382041020062	6 ~ 12		DIN/BT-40-50	382041020061	6 ~ 12
	PSC 63-80	382041020142	14 ~ 20			382041020141	14 ~ 20
		382041032033	3 ~ 5			382041032031	3 ~ 5
1	VCR 32 MONOforce 32	382041032063	6 ~ 12	2	VCR 32 MONOforce 32	382041032061	6 ~ 12
	HSK63-100 MHD'63	382041032143	14 ~ 20		DIN/BT-40	382041032141	14 ~ 20
	PSC 63-80	382041032253	25 ~ 32			382041032251	25 ~ 32
					382041032032	3 ~ 5	
				2	VCR 32 MONOforce 32	382041032062	6 ~ 12
					DIN/BT-50	382041032142	14 ~ 20
						382041032252	25 ~ 32

FORCE

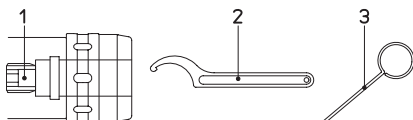

REF	CODE 1	CODE 2	CODE 3
FORCE 12	200100191014	101500400028	201271600400
FORCE 20	200100191615	101500400050	201271600400
FORCE 32	200100191615	101500400075	201271600400

FORCE GH - VT SEALING DEVICE FOR HIGH PRESSURE COOLANT SUPPLY

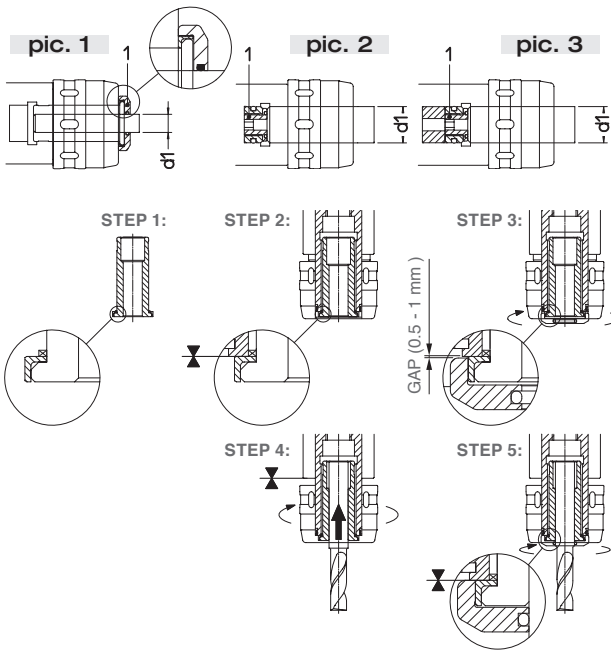

pic.	REF.	CODE 1	d1
1	GH 20 MONOforce 20 HSK63 MHD'50 / DIN/BT-40-50 PSC 63 - 80	382042020061	6
		382042020081	8
		382042020101	10
		382042020121	12
		382042020141	14
382042020161	16		
2	VT 20.20 MONOforce 20 DIN/BT-40-50 HSK63-100 PSC 63-80	382042020201	20
1	GH 32 MONOforce 32 DIN/BT-40-50 / HSK63-100 MHD'63 PSC 63-80	382042032061	6
		382042032081	8
		382042032101	10
		382042032121	12
		382042032141	14
		382042032161	16
		382042032181	18
382042032201	20		
382042032251	25		
2	VT 32.32 MONOforce 32 DIN/BT-40 HSK63-100 PSC 63-80	382042032321	32
3	VT 32.32.100 MONOforce 32 DIN/BT-50	382042032322	32

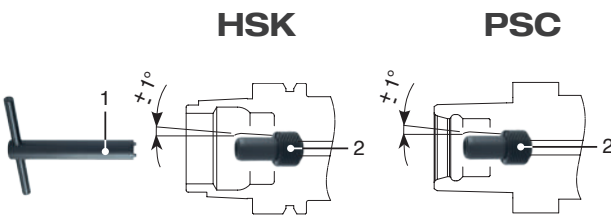

REF.	CODE 1	CODE 2
HSK-A50	101501101400	382019010001
HSK-A63	101501101600	382019012001
HSK-A80	101501101800	382019014001
HSK-A100	101501102200	382019016001
PSC 40	101501200700	382020006001
PSC 50	101501200800	382020007001
PSC 63	101501200900	382020008001
PSC 80	101501201100	382020010001

PSC - TU ISO 26623-1

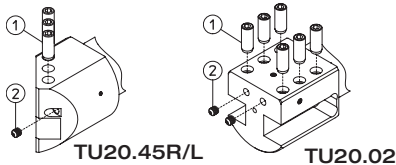

REF.	CODE 1	CODE 2
TCD' PSC 50 TU20.45R/L	100231120025	100585010800
TCD' PSC 63 TU25.45R/L	100231120025	100585010800
TCD' PSC 80 TU32.45R/L	100231120025	100585010800
TCD' PSC 50 TU20.02	100231120025	100585010800
TCD' PSC 63 TU25.02	100231120025	100585010800
TCD' PSC 80 TU32.02	100231120025	100585010800

PSC - D... ISO 26623-1

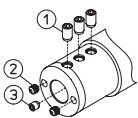

REF.	CODE 1	CODE 2	CODE 3
TCD' PSC 50 D.25x80	100231100016	100585010800	
TCD' PSC 63 D.25x80	100231100016	100585010800	
TCD' PSC 63 D.40x125	100231120020	100585010800	100231080008
TCD' PSC 80 D.25x85	100231100016	100585010800	
TCD' PSC 80 D.40x125	100231120020	100585010800	100231080008

PSC - TU ISO 26623-1

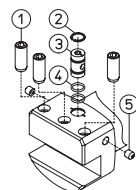

REF.	CODE 1	CODE 2	CODE 3	CODE 4	CODE 5
TCD' PSC 63 TU20.90	100231120025	100900301400	201462501400	101251002043	100580610180
TCD' PSC 63 TU25.90	100231120025	100900301400	201462501400	101251002043	100580610180
TCD' PSC 80 TU32.90	100231120025	100900301400	201462501400	101251002043	100580610180

SS.. 95

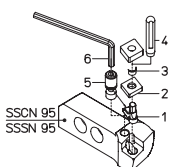

REF.	CODE 1	CODE 2	CODE 3	CODE 4	CODE 5	CODE 6
SSCN 95	491111190600	492031190600	100655095112	101501301408	494311190600	101500100400
SSSN 95	491111190600	492035190600	100655095112	101501301408	494311190600	101500100400