

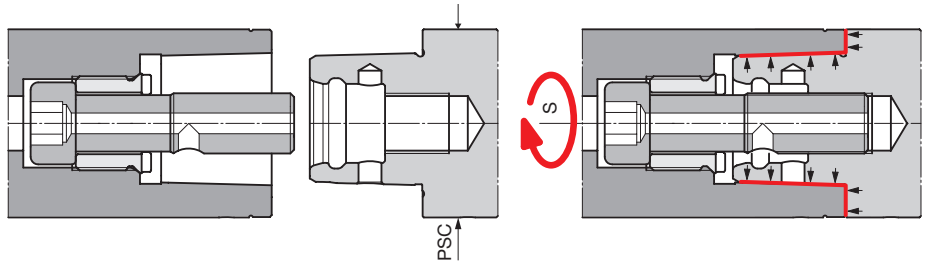

PSC COUPLING ISO 26623-1/2

Line of high-precision monolithic and modular tool holders that allows to perform different operations on the machine-tools.

The strong point of the **PSC** system is the ISO 26623 polygonal-conical connection which guarantees extreme rigidity even in the most demanding process.

The system allows the use of the entire **MHD'** line.



PSC	S 	N·m
40	8	55
50	10	95
63-80	14	170

The **PSC coupling**, compliant with the ISO 26623 standard, is available in four sizes. The system is complete with arbors, extensions, reductions, adapters, roughing and finishing heads. The range includes collet chuck ER and power chucks **MONOFORCE** holders.



PSC - TS complete line of double-bit boring heads for roughing from \varnothing 68 mm to \varnothing 200 mm.



PSC - TRM complete line of micrometric heads for finishing from \varnothing 2.5 mm to \varnothing 220 mm.



ARBORS, manufactured in 4 different sizes **PSC 40-50-63 and 80**, are made of case-hardened, tempered and subsequently ground steel.



PSC - PR e RD for each size of PSC, extensions and reductions are available in different lengths which allow to achieve the required working depths.



MONOforce line of high precision power milling chucks ideal for machining where precision and high clamping forces for the cutting tool are required.



PSC - ER collet holders made for the use of ER standard collets.



PF adapters for side and face milling cutters.



PSC - MHD' adapters to integrate the entire MHD' system boring line into the PSC program.

PSC - PR
Extensions
PSC - RD
Reductions

- PSC50 - PR50
- PSC50 - RD50
- PSC63 - PR63
- PSC63 - RD63
- PSC80 - PR80

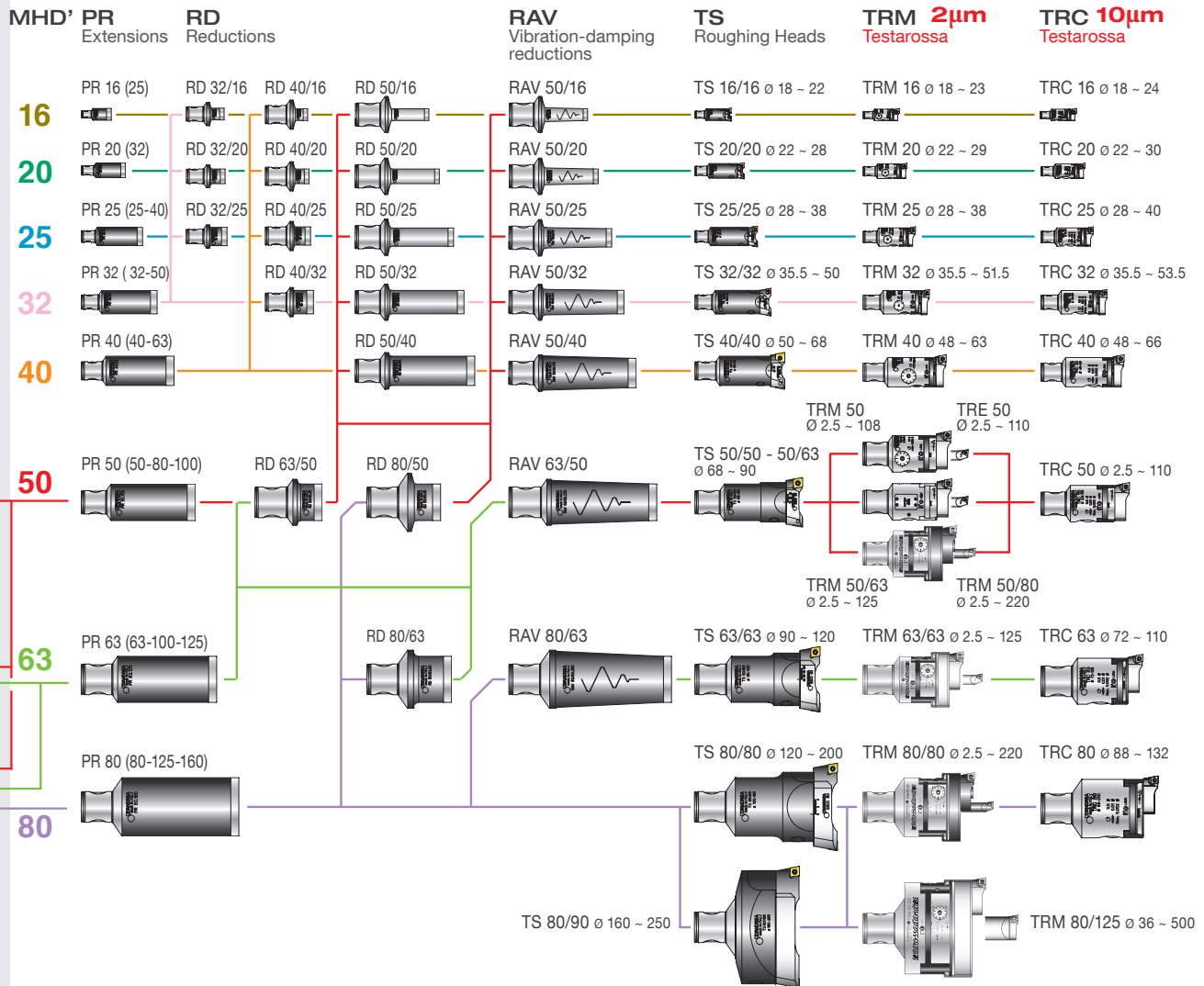
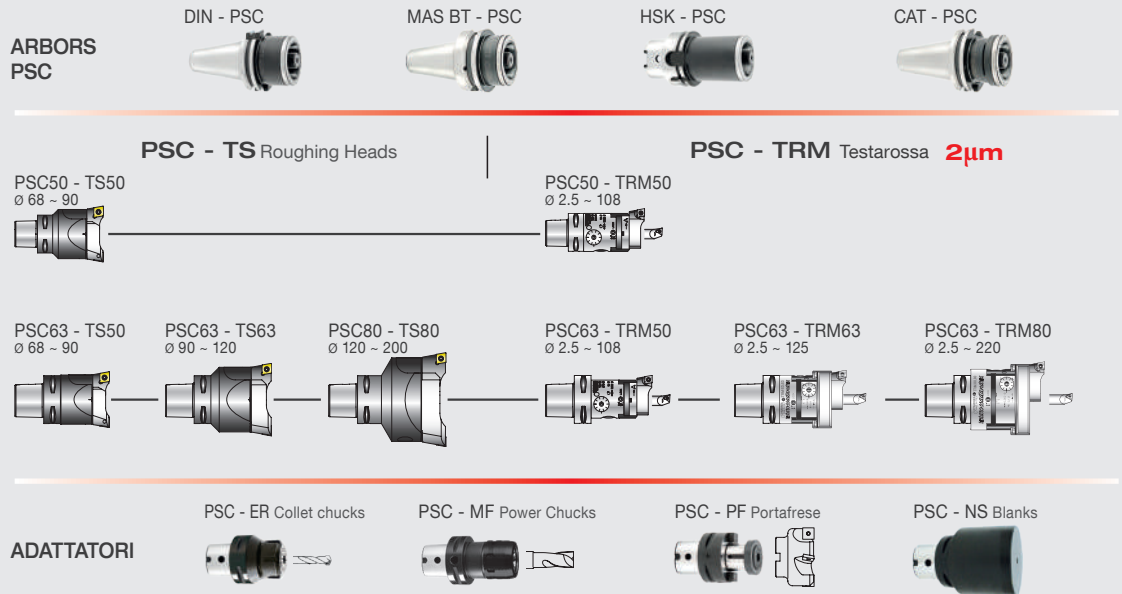

CHUCKING TOOLS



DIN-AD - PSC DIN 69871 / ISO 26623-2

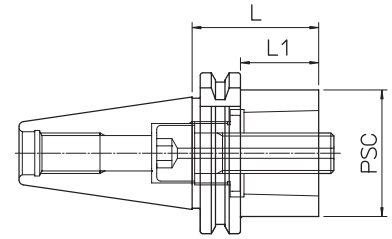
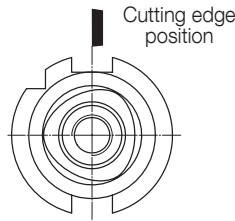

DIN	REF.	CODE	PSC	L	L1	kg		
40	DIN69871-AD40 PSC 50.40	41PS05014028	50	40	21	0.9		
50	DIN69871-AD50 PSC 50.30	41PS05015020	50	30	11	2.7		
50	DIN69871-AD50 PSC 63.30	41PS06315028	63	30	11	2.8		
50	DIN69871-AD50 PSC 80.70	41PS08015020	80	70	51	3.7		

MAS BT-AD - PSC MAS 403 BT / ISO 26623-2

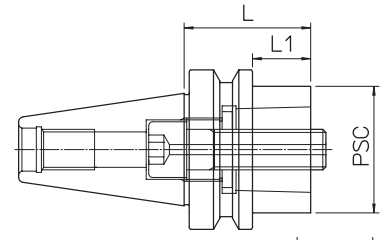
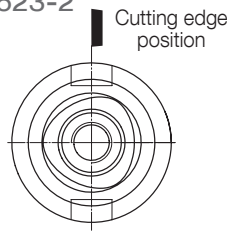

BT	REF.	CODE	PSC	L	L1	kg		
40	MAS403 BT40-AD PSC 50.50	41PS05014032	50	50	23	1.2		
50	MAS403 BT50-AD PSC 50.40	41PS05015030	50	40	2	3.4		
50	MAS403 BT50-AD PSC 63.50	41PS06315032	63	50	12	3.5		
50	MAS403 BT50-AD PSC 80.70	41PS08015030	80	70	32	4		

HSK-T - PSC DIN 69893 / ISO 26623-2

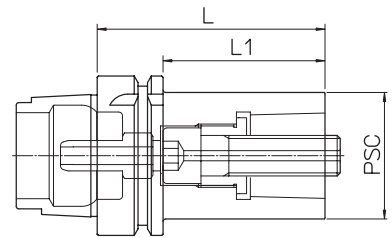
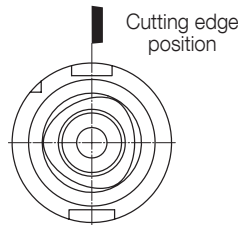

HSK-A	REF.	CODE	PSC	L	L1	kg		Supplied with coolant tube
63	HSK-T63 PSC 40.80	41PS0405632T	40	80	54	1.1		
63	HSK-T63 PSC 50.90	41PS0505632T	50	90	64	1.5		
100	HSK-T100 PSC 50.100	41PS0505992T	50	100	71	3		
100	HSK-T100 PSC 63.110	41PS0635992T	63	110	81	3.6		
100	HSK-T100 PSC 80.120	41PS0805992T	80	120	91	4.7		

CAT-AD - PSC ANSI B5.50 / ISO 26623-2

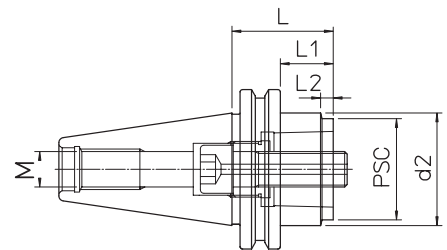
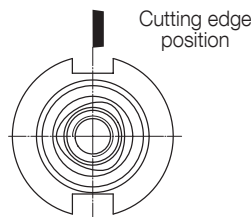

CAT	REF.	CODE	PSC	d2	L	L1	L2	M	kg		
40	CAT40 AD PSC 50.50	41PS05014045	50		50	31		UNC 5/8-11	1		
50	CAT50 AD PSC 50.40	41PS05015045	50	69.9	40	21	5	UNC 1/8	2.5		
50	CAT50 AD PSC 63.50	41PS06315045	63	70	50	31	12.5	UNC 1/8	3		
50	CAT50 AD PSC 80.100	41PS08015045	80		100	81		UNC 1/8	4.6		

PSC - PR ISO 26623-1 / 2

EXTENSIONS

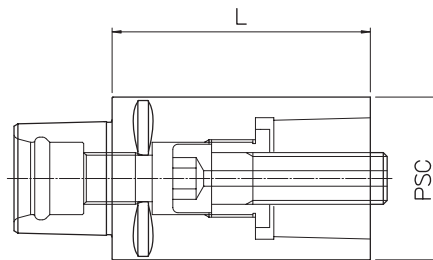
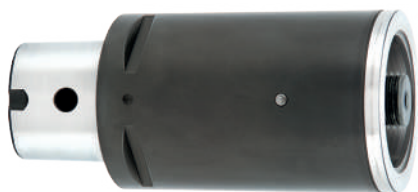

PSC	REF.	CODE	L	kg
40	PR PSC 40.60	656PS04006000	60	0.55
50	PR PSC 50.80	656PS05008000	80	1.1
63	PR PSC 63.100	656PS06310000	100	2.2
80	PR PSC 80.100	656PS08010000	100	3.6

PSC - RD ISO 26623-1 / 2

REDUCTIONS

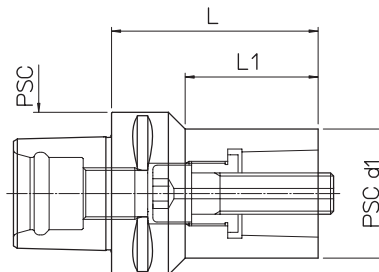

PSC	REF.	CODE	PSCd1	L	L1	kg
50	RD PSC 50/40.65	657PS05004000	40	65	45	0.7
63	RD PSC 63/40.80	657PS06304000	40	80	51.4	1.3
63	RD PSC 63/50.80	657PS06305000	50	80	51.5	1.5
80	RD PSC 80/50.80	657PS08005000	50	80	49.3	2.2
80	RD PSC 80/63.80	657PS08006300	63	80	53.1	2.5

PSC - MHD' ISO 26623-1

REDUCTIONS TO MODULAR

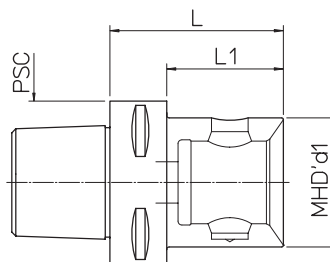

PSC	REF.	CODE	MHD' d1	L	L1	kg
50	PSC 50 - MHD' 50.55	416502605005	50	55		0.8
63	PSC 63 - MHD' 40.50	416402606305	40	50	28	0.9
63	PSC 63 - MHD' 50.55	416502606305	50	55	33	0.8
63	PSC 63 - MHD' 63.77	416632606307	63	77		1.8
80	PSC 80 - MHD' 50.60	416502608006	50	60	30	2
80	PSC 80 - MHD' 63.70	416632608007	63	70	40	2.3
80	PSC 80 - MHD' 80.75	416802608007	80	75		2.6

On request supplied with coolant tube **PSC**. See p.53 

PSC - TS \varnothing 68 ~ 200

Simple and extremely rigid roughing heads, thanks to the serrated surfaces between the head body and the bit holders. The constant distance between the bit holder clamping screw and the cutting edge guarantees the stability of the system.

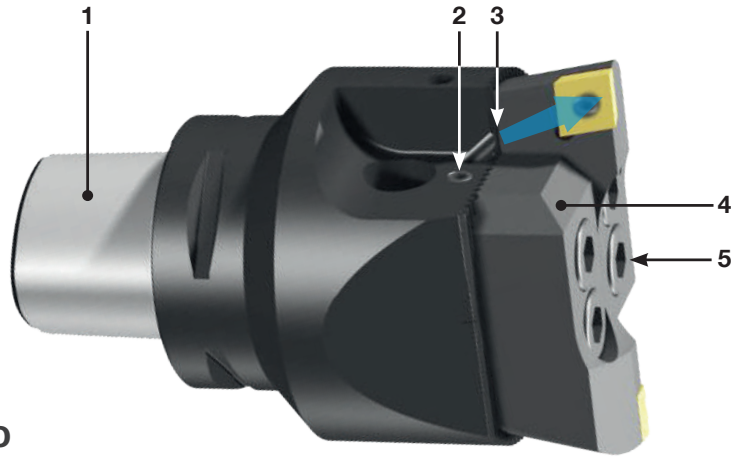

- 1. PSC 50 - 63 - 80
- 2. Setting screws
- 3. Coolant outlets **Max BAR 40**
- 4. Bit holders
- 5. Tools clamp screws

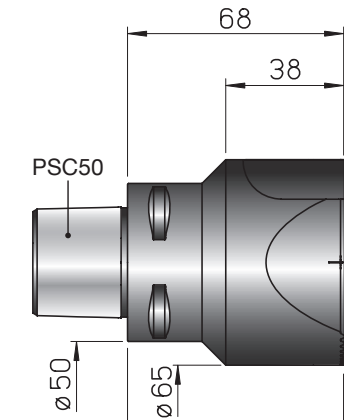

PSC50 - TS50
 \varnothing 68 ~ 90

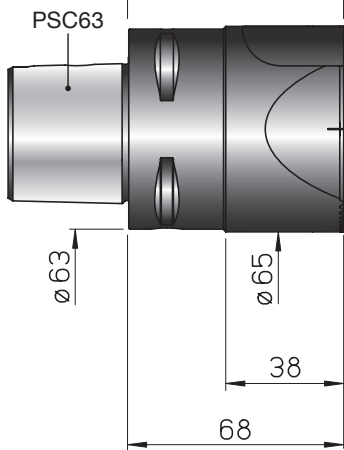
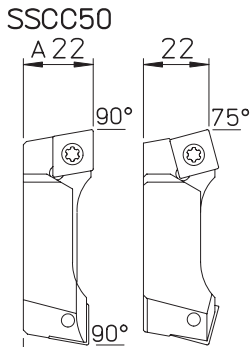

PSC63 - TS50
 \varnothing 68 ~ 90

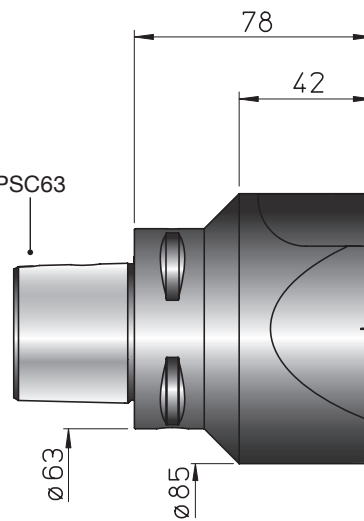

PSC63 - TS63
 \varnothing 90 ~ 120

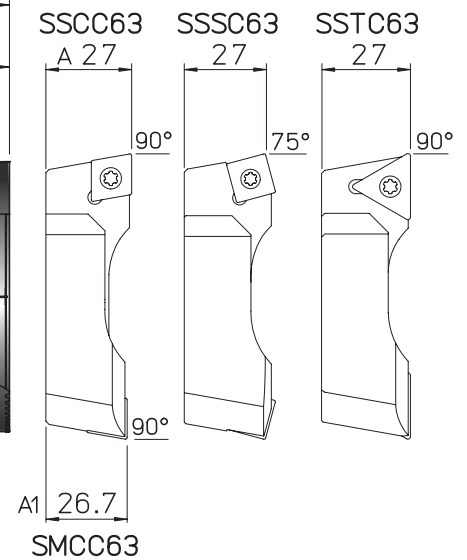

REF.	CODE	kg		
PSC50 - TS50	71PSC050TS50090	1.4		
PSC63 - TS50	71PSC063TS50090	1.8		

REF.	CODE	kg		
PSC63 - TS63	71PSC063TS63105	2.7		
PSC63 - TS80	71PSC063TS80115	3.8		

On request supplied with coolant tube **PSC**. See p.53



USE TS for ROUGHING end SEMI-FINISHING operations

Roughing and semi-finishing operations. Cutting edges might be adjusted on a pre-setting bench and TS heads can be used in three different configurations, with a single cutting edge (**pic. 3**) or misaligned ones (**pic.2**) half the feed.

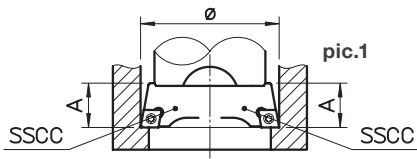

pic.1 with two SSCC bit holders aligned and on the same diameter for roughing operations with high feedrate.

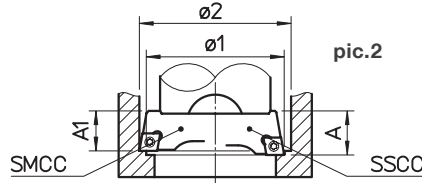

pic. 2 with one SSCC bit holder and one SMCC bit holder staggered and on a different diameter for roughing operations with high depth of cut.

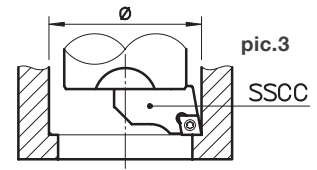

pic.3 with a single bit holder for roughing or semi-finishing operations.

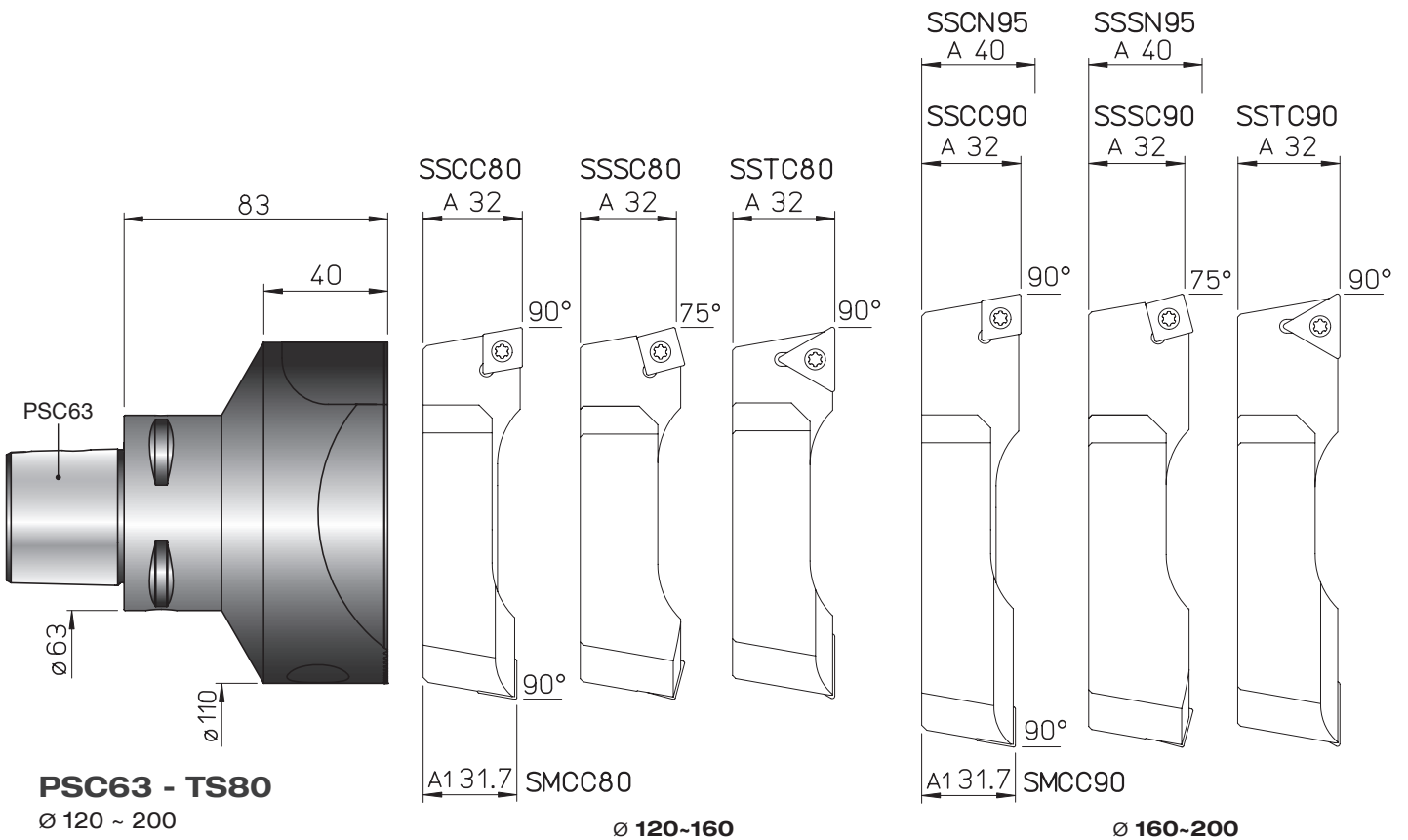

PSC63 - TS80

$\varnothing 120 \sim 200$

REF.	CODE		TS TORX T	kg		
SSCC 50	470500550204	CCMT 1204..	5	25	0.1	
SSCC 63	470500563201	CCMT 1204..	5	25	0.2	
SSCC 80	470500580201	CCMT 1204..	5	25	0.5	
SSCC 90	470500590201	CCMT 1204..	5	25	0.7	
SSCN 95	470500595201	CNM. 1906..			0.9	
SSTC 63	470500563206	TCMT 2204..	5	25	0.2	
SSTC 80	470500580206	TCMT 2204..	5	25	0.5	
SSTC 90	470500590206	TCMT 2204..	5	25	0.7	

REF.	CODE		TS TORX T	kg		
SMCC 50	470500550205	CCMT 1204..	5	25	0.1	
SMCC 63	470500563203	CCMT 1204..	5	25	0.2	
SMCC 80	470500580203	CCMT 1204..	5	25	0.5	
SMCC 90	470500590203	CCMT 1204..	25	08	0.7	
SSSC 50	470500550202	SCMT 1204..	5	25	0.1	
SSSC 63	470500563202	SCMT 1204..	5	25	0.2	
SSSC 80	470500580202	SCMT 1204..	5	25	0.5	
SSSC 90	470500590202	SCMT 1204..	5	25	0.7	
SSSN 95	470500595202	SNM. 1906..			0.9	

• For back-facing machining see p.26

PSC - ER



PSC - FORCE



PSC - PF



PSC - NS



PSC - ER

COLLETS CHUCKING TOOLS

Supplied without collets and clamping wrenches - Chip prearrangement

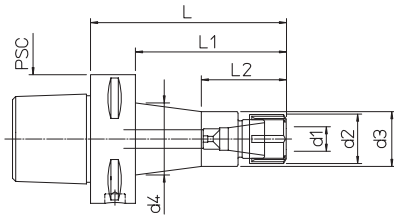

PSC	REF.	CODE	ER	d1	d2	d3	d4	L	L1	L2	kg		
50	PSC50 - ER16.55	71PSC-050ER1605	16M	0.5-10	22	24		55	35	26	0.5		
50	PSC50 - ER25.65	71PSC-050ER2506	25	1-16	42			65	45		0.8		
63	PSC63 - ER16.60	71PSC-063ER1606	16M	0.5-10	22	24		60	38		0.85		
63	PSC63 - ER16.120	71PSC-063ER1612	16M	0.5-10	22	24	31	120	98	33	1.1		
63	PSC63 - ER25.65	71PSC-063ER2506	25	1-16	42			65	43	37	1.1		
63	PSC63 - ER25.140	71PSC-063ER2514	25	1-16	42		47.5	140	118	43.5	1.9		
63	PSC63 - ER32.75	71PSC-063ER3207	32	2-20	50			75	53		1.5		
63	PSC63 - ER32.160	71PSC-063ER3216	32	2-20	50			160	138		2.5		
80	PSC80 - ER25.70	71PSC-080ER2507	25	1-16	42			70	40		2.1		
80	PSC80 - ER32.75	71PSC-080ER3207	32	2-20	50			72	45		2..5		

PSC - FORCE

MILLING POWER CHUCKS

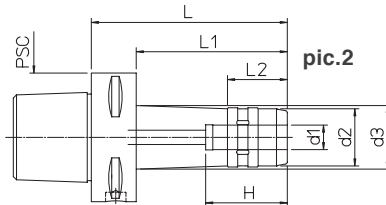
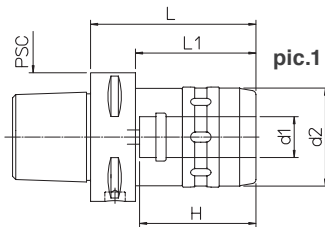

Without clamping wrench - Chip prearrangement

PSC	REF.	CODE	d1	d2	d3	H	L	L1	L2	kg	pic.		
63	PSC 63 - MF 12.100	71PSC-063MF1210	12	28	31.5	46	100	78	29.5	1.4	2		
63	PSC 63 - MF 20.80	71PSC-063MF2008	20	48		60	80	58		1.3	1		
63	PSC 63 - MF 32.100	71PSC-063MF3210	32	66		80	100			2.1	1		
80	PSC 80 - MF 20.80	71PSC-080MF2008	20	48		60	80	50		3.7	1		
80	PSC 80 - MF 32.100	71PSC-080MF3210	32	66		80	100	70		4.4	1		

PSC - PF

SHELL MILL HOLDERS

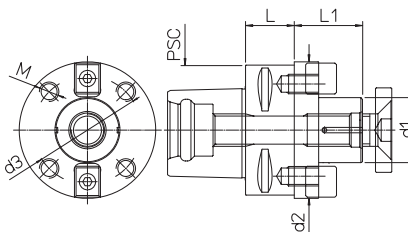

PSC	REF.	CODE	d1	d2	d3	M	L	L1	kg		
50	PSC 50 - PF22.25	71PSC-050PF2202	22				25	19	0.5		
50	PSC 50 - PF27.25	71PSC-050PF2702	27				25	21	0.6		
63	PSC 63 - PF27.25	71PSC-063PF2702	27				25	21	0.8		
63	PSC 63 - PF32.25	71PSC-063PF3202	32				25	24	0.9		
80	PSC 80 - PF32.30	71PSC-080PF3203	32				30	24	1.8		
80	PSC 80 - PF40.45	71PSC-080PF4004	40	84	66.7	M12	45	27	2.4		

PSC - NS

SEMIFINISHED CHUCK HOLDERS

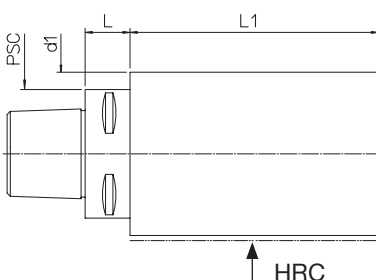

PSC	REF.	CODE	d1	L	L1	kg	HRC		
50	PSC 50 - NS 63.160/140 H.42	71PSC050Z406314	63	20	140	3.8	42		
50	PSC 50 - NS 80.160/140 H.42	71PSC050Z408014	80	20	140	10.2	42		
50	PSC 50 - NS 100.180/160 H.42	71PSC050Z410016	100	22	160	5.9	42		
63	PSC 63 - NS 80.162/140 H.42	71PSC063Z408014	80	22	140	6.2	42		
63	PSC 63 - NS 100.182/160 H.42	71PSC063Z410016	100	22	160	10.4	42		
63	PSC 63 - NS 120.202/180 H.42	71PSC063Z412018	120	22	180	17	42		
80	PSC 80 - NS 100.190/160 H.42	71PSC080Z410016	100	30	160	11.5	42		

On request supplied with coolant tube **PSC**. See p.53



PSC - TRM Ø 2.5 ~ 220

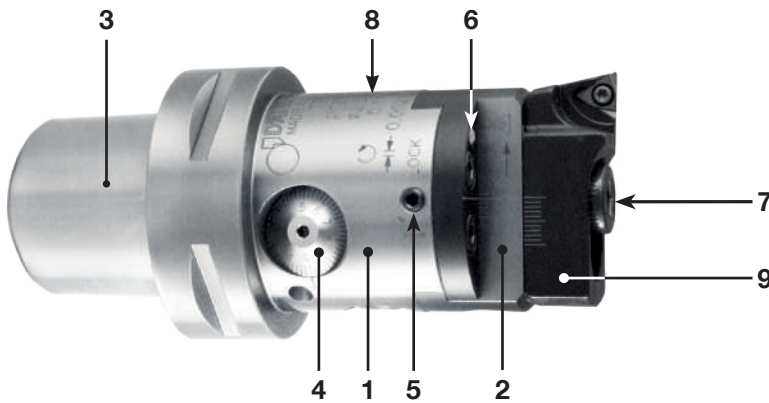

TRM heads allow high precision machining and excellent surface finish in **IT6** grade of tolerance. The adjustment sensitivity of **1 micron** on the radius is easily readable on the vernier scale and can also be performed in the machine.

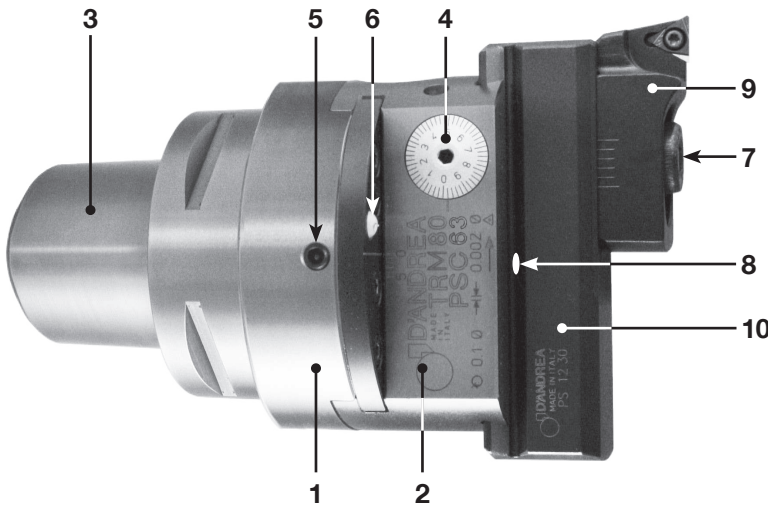

2 µm

- 1. Body
- 2. Slide toolholder
- 3. **PSC 50-63-80**
- 4. Micrometric vernier scale
- 5. Slide clamp screw
- 6. Coolant outlet
- Max BAR 40
- 7. Tools clamp screws
- 8. Oiler
- 9. Bit holder
- 10. Tool holder

PSC50 - TRM50
Ø 2.5 ~ 108

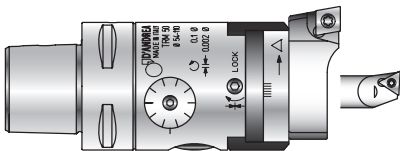

PSC63 - TRM50
Ø 2.5 ~ 108

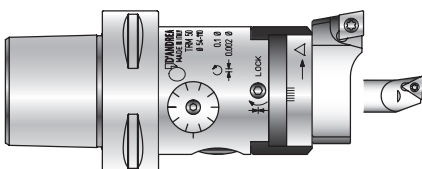

PSC63 - TRM63
Ø 2.5 ~ 125

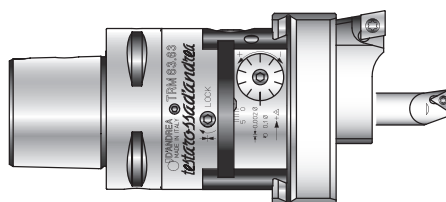

PSC63 - TRM80
Ø 2.5 ~ 220



PSC50 - TRM50

Ø 2.5 ~ 108

PSC63 - TRM50

Ø 2.5 ~ 108



2 µm

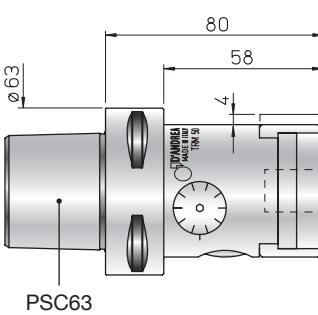
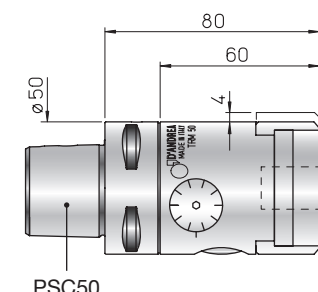
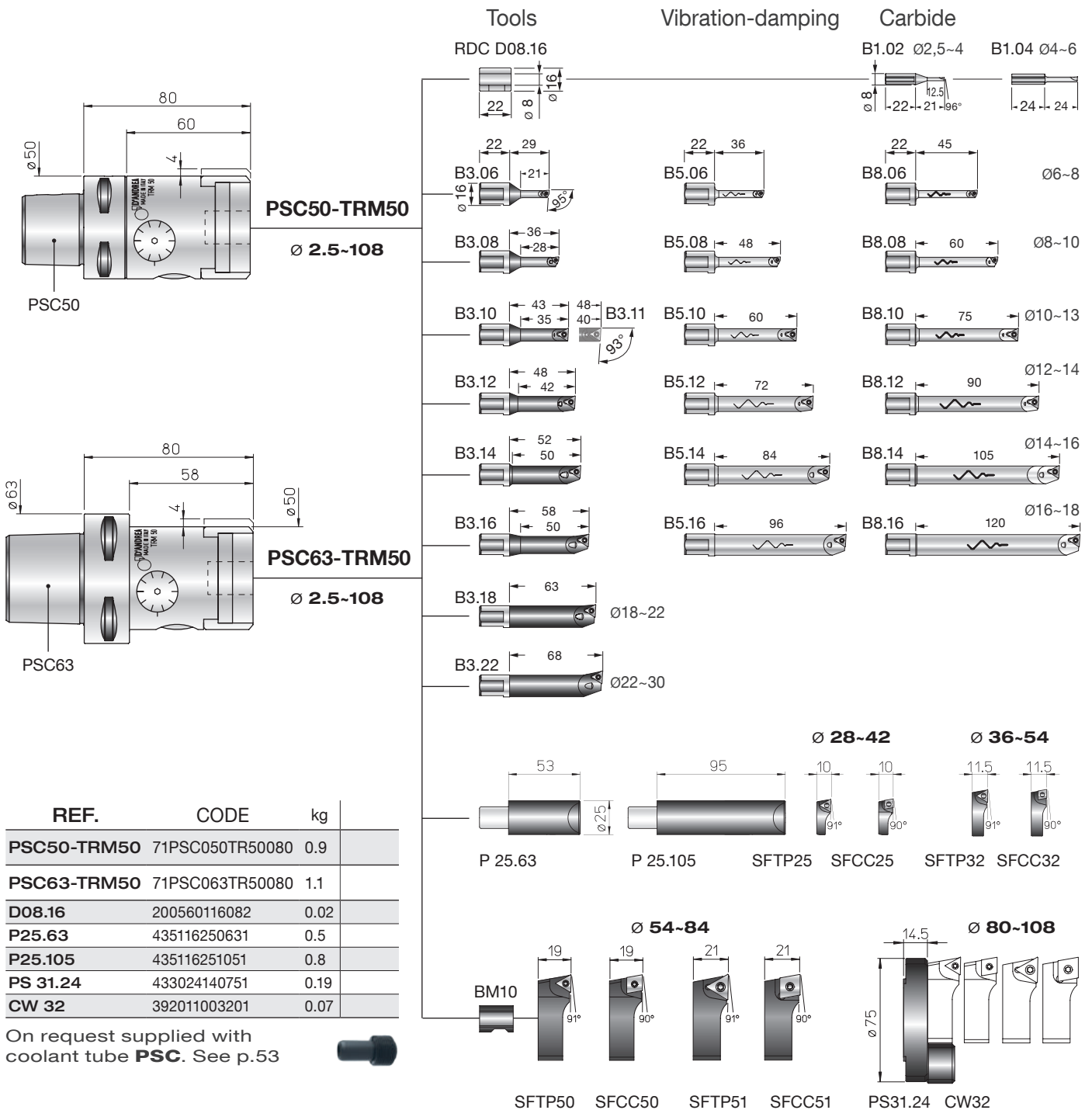

REF.	CODE	kg
PSC50-TRM50	71PSC050TR50080	0.9
PSC63-TRM50	71PSC063TR50080	1.1
D08.16	200560116082	0.02
P25.63	435116250631	0.5
P25.105	435116251051	0.8
PS 31.24	433024140751	0.19
CW 32	392011003201	0.07

On request supplied with coolant tube **PSC**. See p.53



KIT K01 PSC50 - TRM50

Ø 6 ~ 108



1 PSC50-TRM50 1 SFTP 25
 1 B3.06 1 SFTP 32
 1 B3.08 1 SFTP 50
 1 B3.11 1 P 25.63
 1 B3.16 1 PS 31.24
 1 B3.22 1 CW 32

5 TPGX 090202L DC100
 1 TPGX 110302L DC100
 2 WCGT 020102L DC10

KIT K01 PSC63 - TRM50

Ø 6 ~ 108



1 PSC63-TRM50 1 SFTP 25
 1 B3.06 1 SFTP 32
 1 B3.08 1 SFTP 50
 1 B3.11 1 P 25.63
 1 B3.16 1 PS 31.24
 1 B3.22 1 CW 32

5 TPGX 090202L DC100
 1 TPGX 110302L DC100
 2 WCGT 020102L DC10

REF.	CODE	kg		
KIT K01 PSC50-TRM50	7KPSC050TR50080	3.5		

REF.	CODE	kg		
KIT K01 PSC63-TRM50	7KPSC063TR50080	4.2		

KIT K01 PSC50-TRM50 / PSC63-TRM50

Working Range

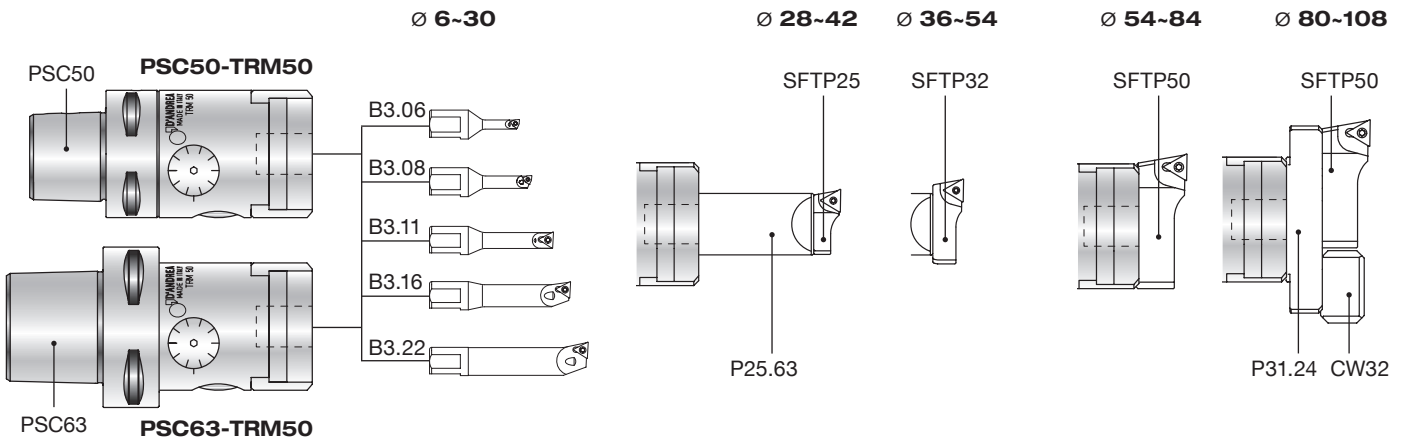

REF.	CODE		TORX T	kg
B1.02	572010502001			0.02
B1.04	572010504001			0.02
B3.06	572010506001	WCGT0201..	TS 21 06	0.035
B3.08	572010508001	WCGT0201..	TS 211 06	0.4
B3.10	572010510001	TPGX0902..	CS 250 T 08	0.05
B3.11	572010511001	TPGX0902..	CS 250 T 08	0.055
B3.12	572010512001	TPGX0902..	CS 250 T 08	0.06
B3.14	572010514001	TPGX0902..	CS 250 T 08	0.07
B3.16	572010516001	TPGX0902..	CS 250 T 08	0.07
B3.18	572010518001	TPGX0902..	CS 250 T 08	0.1
B3.22	572010522001	TPGX0902..	CS 250 T 08	0.1

REF.	CODE		TORX T	kg
B5.06	572010506105	WCGT0201..	TS 21 06	0.075
B5.08	572010508105	WCGT0201..	TS 211 06	0.09
B5.10	572010510105	TPGX0902..	CS 250 T 08	0.1
B5.12	572010512105	TPGX0902..	CS 250 T 08	0.1
B5.14	572010514105	TPGX0902..	CS 250 T 08	0.2
B5.16	572010516105	TPGX0902..	CS 250 T 08	0.3
B8.06	572010506108	WCGT0201..	TS 21 06	0.065
B8.08	572010508108	WCGT0201..	TS 211 06	0.08
B8.10	572010510108	TPGX0902..	CS 250 T 08	0.1
B8.12	572010512108	TPGX0902..	CS 250 T 08	0.2
B8.14	572010514108	TPGX0902..	CS 250 T 08	0.2
B8.16	572010516108	TPGX0902..	CS 250 T 08	0.3

REF.	CODE		TORX T	kg
SFTP25	470500525001	TPGX0902..	CS 250T 08	0.01
SFTP32	470500532001	TPGX0902..	CS 250T 08	0.02
SFTP50	470500550001	TPGX1103..	CS300890T 08	0.08
SFTP51	470500550003	TCMT16T3..	TS 4 15	0.09

REF.	CODE		TORX T	kg
SFCC25	470500525002	CCGT0602..	TS 25 08	0.01
SFCC32	470500532002	CCGT0602..	TS 25 08	0.02
SFCC50	470500550002	CCGT09T3..	TS 4 15	0.08
SFCC51	470500550004	CCMT1204..	TS 5 25	0.09

• For back-facing machining see p.26

PSC63 - TRM63

Ø 2.5 ~ 125



PSC63 - TRM80

Ø 2.5 ~ 220



2 μm

Tools

PSC63 TRM63
Ø 2.5-125

Vibration-damping

PSC63 TRM80
Ø 2.5-220

Carbide

PSC63 TRM80
Ø 2.5-220

REF.	CODE	kg
PSC63-TRM63	71PSC063TR63080	1.5
PSC63-TRM80	71PSC063TR80080	2
D08.16	200560116082	0.02
P20.30	431030160300	0.2
P02.30	431030250400	0.3
P03.30	431030250700	0.4
P04.30	431030251150	0.7
PS 11.30	433030260750	0.4
PS 12.30	433030260950	0.5
PS 13.30	433030261400	0.7

On request supplied with coolant tube **PSC**. See p.53

P02.30

P03.30

P04.30

PS11.30

PS12.30

PS13.30

<p>B3.06</p>	<p>B5.06</p>	<p>B8.06</p>
<p>B3.08</p>	<p>B5.08</p>	<p>B8.08</p>
<p>B3.10</p>	<p>B5.10</p>	<p>B8.10</p>
<p>B3.12</p>	<p>B5.12</p>	<p>B8.12</p>
<p>B3.14</p>	<p>B5.14</p>	<p>B8.14</p>
<p>B3.16</p>	<p>B5.16</p>	<p>B8.16</p>
<p>B3.18</p>	<p>B3.22</p>	<p>B1.02 Ø2,5-4</p>
<p>B1.04 Ø4-6</p>	<p>Ø 30-83</p> <p>TRM63 Ø 30-66</p> <p>TRM80 Ø 30-83</p> <p>SFTP25</p> <p>SFCC25</p>	
<p>Ø 35.5-95</p> <p>TRM63 Ø 35.5-77</p> <p>TRM80 Ø 35.5-95</p> <p>SFTP32</p> <p>SFCC32</p>		<p>SFTP50</p> <p>SFCC50</p>
<p>Ø 77-220</p> <p>SFTP51</p> <p>SFCC51</p>		

<p>TRM63 Ø 77-100</p>	<p>TRM63 - TRM80 Ø 95-125 - Ø 95-140</p>	<p>TRM80 Ø 140-220</p>
----------------------------------	---	-----------------------------------

38

KIT K01 PSC63 - TRM63

Ø 6 ~ 125



1 PSC63 - TRM63

- 1 P20.30 1 B3.11
- 1 PS11.30 1 B3.16
- 1 P02.30 1 B3.22
- 1 P03.30 1 SFTP25
- 1 B3.06 1 SFTP32
- 1 B3.08 1 SFTP50

- 5 TPGX 090202L DC100
- 1 TPGX 110302L DC100
- 2 WCGT 020102L DC 10

REF.	CODE	kg
KIT K01 PSC63-TRM63	7KPSC063TR63080	5.5

KIT K01 PSC63 - TRM80

Ø 6 ~ 220



1 PSC63 - TRM80

- 1 P20.30 1 B3.08
- 1 PS12.30 1 B3.11
- 1 PS13.30 1 B3.16
- 1 P02.30 1 B3.22
- 1 P03.30 1 SFTP25
- 1 P04.30 1 SFTP32
- 1 B3.06 1 SFTP50

- 5 TPGX 090202L DC100
- 1 TPGX 110302L DC100
- 2 WCGT 020102L DC 10

REF.	CODE	kg
KIT K01 PSC63-TRM80	7KPSC063TR80080	6.5

KIT K01 PSC63 - TRM63

Working Range

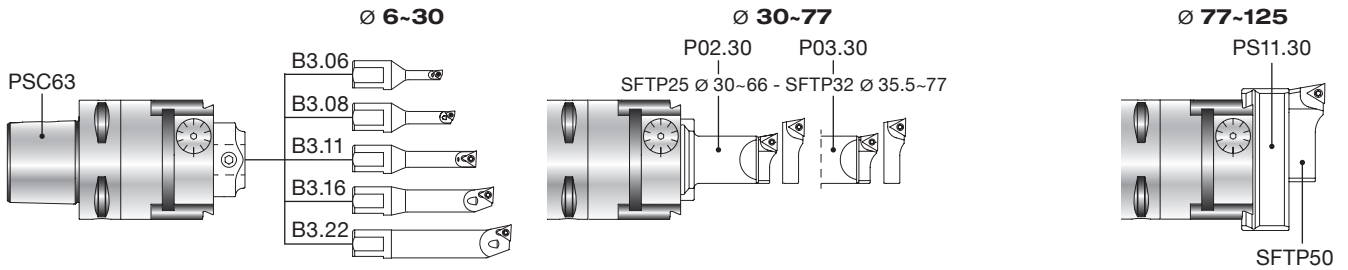

KIT K01 PSC63 - TRM80

Working Range

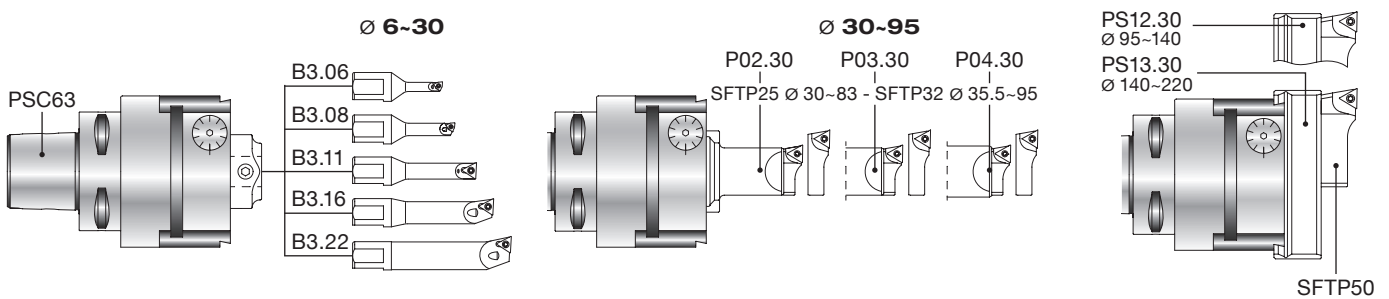

REF.	CODE	TORX T	kg
B1.02	572010502001		0.02
B1.04	572010504001		0.02
B3.06	572010506001	WCGT0201.. TS 21 06	0.035
B3.08	572010508001	WCGT0201.. TS 211 06	0.4
B3.10	572010510001	TPGX0902.. CS 250 T 08	0.05
B3.11	572010511001	TPGX0902.. CS 250 T 08	0.055
B3.12	572010512001	TPGX0902.. CS 250 T 08	0.06
B3.14	572010514001	TPGX0902.. CS 250 T 08	0.07
B3.16	572010516001	TPGX0902.. CS 250 T 08	0.07
B3.18	572010518001	TPGX0902.. CS 250 T 08	0.1
B3.22	572010522001	TPGX0902.. CS 250 T 08	0.1
B5.06	572010506105	WCGT0201.. TS 21 06	0.075
B5.08	572010508105	WCGT0201.. TS 211 06	0.09
B5.10	572010510105	TPGX0902.. CS 250 T 08	0.1
B5.12	572010512105	TPGX0902.. CS 250 T 08	0.1
B5.14	572010514105	TPGX0902.. CS 250 T 08	0.2
B5.16	572010516105	TPGX0902.. CS 250 T 08	0.3
B8.06	572010506108	WCGT0201.. TS 21 06	0.065
B8.08	572010508108	WCGT0201.. TS 211 06	0.08
B8.10	572010510108	TPGX0902.. CS 250 T 08	0.1
B8.12	572010512108	TPGX0902.. CS 250 T 08	0.2
B8.14	572010514108	TPGX0902.. CS 250 T 08	0.2
B8.16	572010516108	TPGX0902.. CS 250 T 08	0.3

REF.	CODE	TORX T	kg
SFTP25	470500525001	TPGX0902.. CS 250T 08	0.01
SFTP32	470500532001	TPGX0902.. CS 250T 08	0.02
SFTP50	470500550001	TPGX1103.. CS300890T 08	0.08
SFTP51	470500550003	TCMT16T3.. TS 4 15	0.09
SFCC25	470500525002	CCGT0602.. TS 25 08	0.01
SFCC32	470500532002	CCGT0602.. TS 25 08	0.02
SFCC50	470500550002	CCGT09T3.. TS 4 15	0.08
SFCC51	470500550004	CCMT1204.. TS 5 25	0.09

• For back-facing machining see p.26

TCD' is the turning tools line made according to the ISO 26623-1 **PSC** standards for Application on MULTI-TASK machines. The **TCD'** program consists of turning tools adapters. The **TCD'** line is prepared with the coolant way.

PSC - TU ISO 26623-1

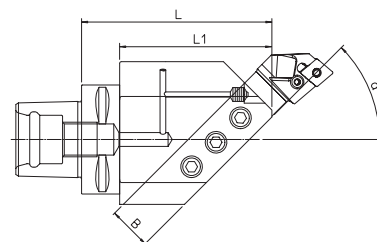
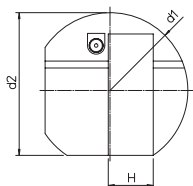

Right hand tool holder shown. A standard Application requires left hand tools with right hand adapters.

PSC	REF.	CODE	L	L1	d1	d2	a°	BxH	kg
50	TCD' PSC50 - TU20.45R	71PSC050T2045R1	90	70	72	65	45°	20x20	1.8
50	TCD' PSC50 - TU20.45L	71PSC050T2045L1	90	70	72	65	45°	20x20	1.8
63	TCD' PSC63 - TU25.45R	71PSC063T2545R1	110	88	90	82.5	45°	25x25	3.5
63	TCD' PSC63 - TU25.45L	71PSC063T2545L1	110	88	90	82.5	45°	25x25	3.5
80	TCD' PSC80 - TU32.45R	71PSC080T3245R1	135	105	115	98.5	45°	32x32	6.4
80	TCD' PSC80 - TU32.45L	71PSC080T3245L1	135	105	115	98.5	45°	32x32	6.4

PSC - TU ISO 26623-1

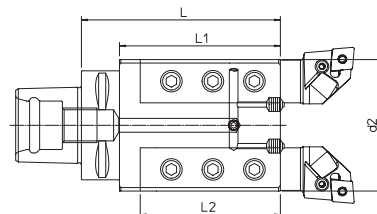
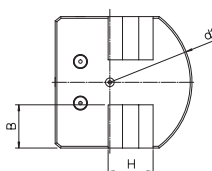

PSC	REF.	CODE	L	L1	L2	d1	d2	BxH	kg
50	TCD' PSC50 - TU20.02	71PSC050T200201	100	80	64	80	63	20x20	2.5
63	TCD' PSC63 - TU25.02	71PSC063T250201	115	93	80	95	76	25x25	4
80	TCD' PSC80 - TU32.02	71PSC080T320201	125	95	80	115	86	32x32	6.2

PSC - TU ISO 26623-1

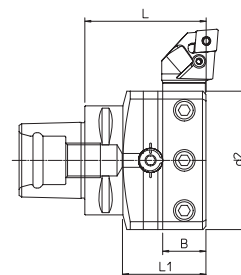
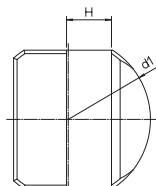

PSC	REF.	CODE	L	L1	d1	d2	BxH	kg
50	TCD' PSC50 - TU20.90	71PSC050T209001	60	40	80	64	20x20	1.4
63	TCD' PSC63 - TU25.90	71PSC063T259001	70	48	95	80	25x25	2.6
80	TCD' PSC80 - TU32.90	71PSC080T329001	85	55	133	105	32x32	5.2

PSC - D... ISO 26623-1

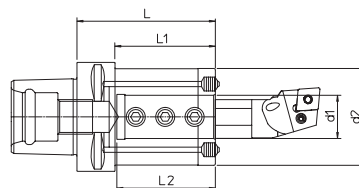

PSC	REF.	CODE	d1H7	d2	L	L1	L2	kg	Reduction bushes on request
50	TCD' PSC50 - D.25x80	71PSC050D250801	25	56	80	60	58	1.4	
63	TCD' PSC63 - D.25x80	71PSC063D250801	25	56	80	58	58	1.7	
63	TCD' PSC63 - D.40x125	71PSC063D401201	40	80	125	103	85	3.9	
80	TCD' PSC80 - D.25x85	71PSC080D250801	25	56	85	55	58	2.6	
63	TCD' PSC80 - D.40x125	71PSC080D401201	40	80	125	95	85	4.6	

On request supplied with coolant tube **PSC**. See p.53

